

MO 10



Designed by Walker Marine Design, UK – The MO10 was designed and built to perform a multitude of tasks, including crew transfer, offshore bunkering and cargo operations. Capable of transferring personal in 2m Hs, the MO10 is one of only a handful of vessels capable of achieving this milestone in passenger transfer.

Exceptional heavy cargo transfers are possible due to her exceptional cargo carry capacity of 140m² deck space and 30-ton payload.

General

DESIGN:	Walker Marine Design, UK
CONSTRUCTION:	Aluminum
FLAG:	UK
CLASS:	BV – HSOSC 60Nm
CAPACITY:	24 Industrial personnel, 3 crew
MMSI:	TBC
CALL SIGN:	TBC

Dimensions

LENGTH OVERALL:	26.0m
BEAM:	10.0m
DRAUGHT:	3.0m
FUEL CAPACITY:	40,000Ltrs
WATER CAPACITY:	2,000Ltrs
CARGO AREA FWD:	90m ²
CARGO CAPACITY FWD:	20t
CARGO AREA AFT:	50m ²
CARGO CAPACITY AFT:	10t

Propulsion

MAIN ENGINES:	2x Caterpillar C32B
MAX POWER:	3300 kW
MAX RPM:	2300 PRM
GEARBOXES:	2x ZF
PROPULSION:	Controllable pitch - CPP
BOW THRUSTER:	Hydraulic

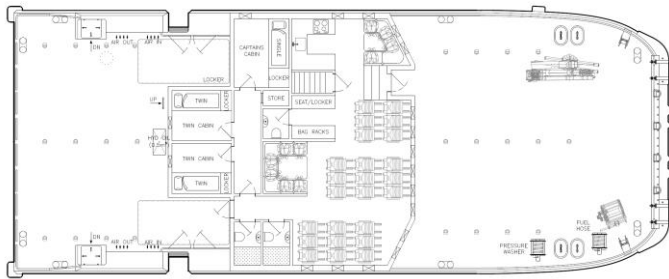
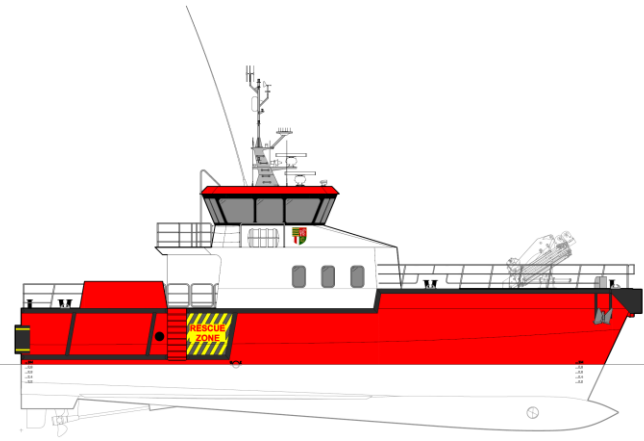

Bridge Systems

MAIN RADAR:	Furuno FAR-2127-BB ARPA- AIS
AUX RADAR:	Furuno DSR12A-AIS
MF-HF:	Furuno FS-1571 MF/HF GMDSS
ECDIS 1:	Furuno Navmaster v9
ELECTRONIC CHART DISPLAY:	Furuno NavNet
SOUNDER:	FC V1150
HEADING:	Furuno SC50, Koden sat compass, Furuno PG700
POSITION:	Furuno SC30, Furuno GP30, Koden
AIS:	Furuno FA150 Class A
CCTV:	Dedicated recording system
INTERNET:	Wi-Fi / 4G
VHF:	3x Sailor

Electrical Equipment

GENERATOR:	Caterpillar C2.2, 21 kW
POWER UNIT:	Master-Volt inverter

Performance

SPRINT SPEED:	31 Kts
FUEL BURN - SPRINT SPEED:	450 L/Hr
CRUISING SPEED:	28 Kts
FUEL BURN – CRUISING SPEED:	350 L/Hr
TRANSFER LIMIT:	2.0m Hs
BOLLARD PUSH:	25t

Additional Equipment

FUEL TRANSFER:	500 Liters per Min
CRANE:	Call For info
BOW FENDER:	RG Seasight
STERN FENDER:	RG Seasight

Welfare Onboard

Built with passenger comfort in mind, with fully adjustable suspension seats throughout. Comfortable and practical mess area complete with a fully functioning galley. Additional features include: crew cabins; showers; dual toilets; air conditioning; heating; with generous space for luggage and spares.



MAINPRIZE OFFSHORE
Offshore Maritime Support

Certification Number 11166